



SPORTS WATER PITCHER

USER GUIDE

www.VYVwater.com

THANK YOU

Thank you for choosing the VYV Sports Water Pitcher. Please follow the easy instructions to get started. To learn about VYV please visit: www.VYVwater.com.

WHAT'S INCLUDED

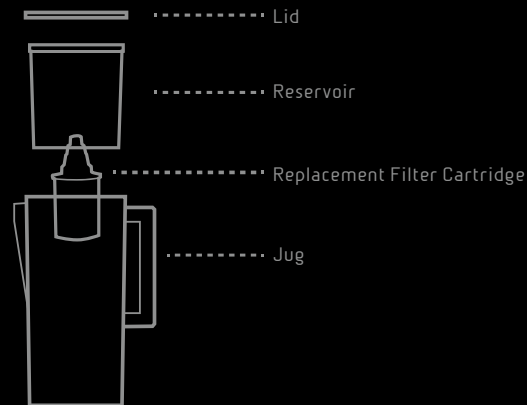

GETTING STARTED



1/ Soak filter in cold water for 15 minutes.



2/ Clean the reservoir and pitcher by hand using a mild detergent and water.



3/ Screw filter into bottom of reservoir. Place the reservoir back into the pitcher.

TIP: when placing back the reservoir be sure to match the indented holes on the top sides for the correct fit.



4/ Fill the reservoir with cold water, and let it filter through.

NOTE: never use hot water. Fill by pouring water on side of reservoir rather than directly on top of the filter cartridge.



5/ Discard this water and repeat 2 more times to rinse away loose activated carbon before use.

GETTING STARTED... CONTINUED



6/ Place lid on top. To ensure a tight fit and prevent spillage, start with the logo facing towards the spout and insert the lid on either left or right side before pushing down.



7/ The pitcher should be periodically maintained by cleaning it with mild soapy water and dried with a soft cloth. Please be sure to remove the filter cartridge prior to cleaning.

NOTE: to help prolong the life of the filter cartridge, it is recommended to keep it in contact with water as much as possible. One method is to leave the pitcher filled up overnight.

SETTING THE FILTER CARTRIDGE LIFE INDICATOR

1/ Press and hold button down for few seconds until the face icon appears, then release button.

2/ Set the number of users by pressing the button until the desired number is achieved.

3/ Press and hold the button for few seconds until the filter cartridge symbol appears. The indicator is now ready.

TIP: to reset indicator in case of an error or when replacing a filter simply press and hold the button down until the indicator shuts off.

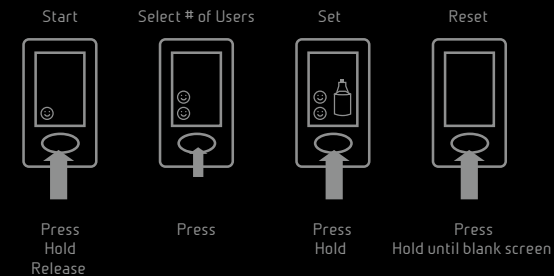

WHEN TO REPLACE THE FILTER CARTRIDGE



When the life indicator shows the filter cartridge symbol with a "X" blinking you should replace the filter within a week.

NOTE: the indicator is based on a calculated time for an average user. For best performance, we recommend changing your filter every 2-3 months.

HOW TO REPLACE THE FILTER CARTRIDGE



1/ Unscrew the used filter cartridge and discard



2/ Screw the new filter cartridge into the base of reservoir



3/ Reset the indicator

FOR BEST RESULTS

Due to the acid neutralizing properties of the water, it is recommended to start off drinking a few glasses per day before increasing consumption. The water is not recommended for young infants.

Do not pour carbonated drinks, milk, coffee, tea or any other liquids besides cold water in the VYV pitcher. Doing so may damage the cartridge filter properties

Do not microwave or heat the VYV pitcher up. If left outside of the fridge, please store it in a cool, dry area.

Patients with weak kidneys, heart issues, liver cirrhosis, allergy or stomach problems should always consult with their physician first before drinking

If any unusual symptoms occur please stop and consult with your physician. NOTE: some people have experienced minor detoxing effects which is perfectly normal. If symptoms persist for longer than 2 days please consult with your physician.

If the filter becomes clogged or the water appears cloudy, this is due to a natural calcification process when the filter becomes dry, and is completely safe. Simply remove the filter and give it a few shakes before inserting it back to the reservoir. Run the water through and let it filter a few times until it becomes cleared. To avoid clogging or cloudy water simply keep the filter immersed in water.

TECHNICAL SPECIFICATIONS

Capacity: 5 cups (1.25 L)

Jug Material: AS

Lid & Reservoir: ABS

Cartridge Housing: PP



To learn more visit us at:
www.VYVwater.com